

MANFREDI



dental catalogue



MANER

   italian tecnology since 1934

**Our quality  
is certified**



**since 1997**

# everywhere... everyday



## with you

### Growing together

Progress in technology rushes everyday faster and faster. To keep pace with it, our efforts are incessant, and we have to mix everyday technical knowledge with imagination and design.

This edition of Manfredi dental catalogue is a confirmation of our efforts in this direction.

### Better performance for a better result with EBST

The centrifugal induction casting machines have been improved in their reliability.

NEUTRODYN HD, MILLENNIUM HD, EPHESTOS and AURUM 2 are now equipped with EBST (Electronic Board Selected Tolerance). Thanks to EBST we can grant an heavy duty cycle work up to 40 continuous castings.

### Successful vacuum pressure casting with EPHESTOS

Hundreds of dental labs are today using the vacuum pressure casting EPHESTOS coming from many years' experience guaranteeing a perfect melting of the metal: essential condition for a successful casting with precious and non precious alloys.

### Titanium

After years of experience in implantology, it has been clinically proved that titanium is the unique metal that does not cause problems of galvanism and allows the passivation of the prosthesis on implants.

The technique of bars tightly joins implantology, titanium and laser welding: the perfect combination.

More and more, the Easyti System® is recognized as complementary method to the implants technology.

### The laser welder GALILEO

Thanks to the experience with the previous models of laser welder, MANFREDI is proud to introduce GALILEO. Compact, small, nice, ergonomic, GALILEO guarantees, at a very reasonable price, a powerful equipment (up to 70 joule) allowing perfect weldings with every metal.

### The new line of micromotors

The performances required from a micromotor are so different, depending on the job to execute, thus making impossible to satisfy the dental technicians with only one or two models: that's why we are offering today a line of 4 models to cover in full the dental labs needs.

### KALOSTERY autoclaves

Manfredi is expanding more and more his product line also in the dental practice. KALOSTERY is a line of autoclaves sterilizers available in the classes B - S - N in 18 and 23 liters sizes. For more safety the USB device is optionally available to have a second record in case of problems on the printer.

### Our service

We consider our service a point of excellence. Speaking the most common European languages, our engineers inside the company are ready to help and support you.

### Our training courses

In the years hundreds of people have been trained to assist the users of Manfredi equipment to install, operate, maintain and repair them.

### SAED Line

Thanks to our long-time experience, we can be your best partner in projecting and installing dental labs, schools and training centers: one more chance to grow together.

### SALUS Life

STERYFAST-P is the leading product of the Salus Life line. Used in surgical instruments and surface disinfection, it acts against bacteria, fungi, virus and spores performing a certified reduction of the microbial charge of more than 99,99%.



**MILLENNIUM HD**  
with EBST  
(Electronic Board Selected Tolerance)



**EPHESTOS**  
vacuum pressure casting  
with EBST



**GALILEO**  
the strong and compact  
laser welder



**KALOSTERY**  
the most updated and complet  
line of sterilization autoclaves

Up to few years ago the Titanium dental prosthesis was still considered a rare novelty. Thanks to the patented **EASYTI SYSTEM**®, titanium is every day more and more popular and there are no limits in its use in the dental lab.

**EASYTI SYSTEM**® The simplest way to make dental prosthesis in straight titanium. This system is used daily by almost 1000 laboratories in over 30 countries and has proved to be the most cost-effective system considering that the casting and welding machines in the **EASYTI SYSTEM**® program may be used with any other dental alloy with excellent results.

In order to fully exploit the possibilities offered by the **EASYTI SYSTEM**®, we recommend to attend one of our courses thought really with this purpose.

### NEUTRODYN EASYTI HD

- Induction casting machine with great flexibility, which may be used in either natural atmosphere, or vacuum or inert atmosphere (Argon).
- Casting of precious and non-precious metals and **titanium**.
- Titanium casting cycle protected under international patent right.
- Equipped with a **new high efficiency solid state generator with EBST (Electronic Board Select Tolerance)** granting heavy duty cycle work up to 40 continuous castings.
- **Self-diagnosis of circuits and safety devices.**
- **Melting power setting feature.**
- Continuous-reading control and stabilization of the temperature in the range from 800 to 2000° C.
- Equipped with motor acceleration regulator to control the metal flow to the ring.
- Built-in cooling system.
- Use of crucibles in ceramic, coated ceramic, graphite or sintered graphite.
- Cylinder holder adjustable on the diameter and the height of the cylinder in use.  
(For more details see page 6)

**Starting Kit:** Set of stainless steel rings - Universal rubber sprue former - Crucibles for titanium, precious and non-precious alloys - Ceramic stirring rod - Safety goggles.

230 Volts - 50 Hz

M47A4

230 Volts - 60 Hz

M47A401

### NEUTOR TI

- Induction casting machine with great flexibility, may be used in either natural atmosphere, or vacuum or inert atmosphere (Argon).
- Casting of precious and non-precious metals, and **titanium**.
- **Titanium** casting cycle protected under international patent right.
- Suitable for large laboratories, for continuous casting.
- Using large-sized crucibles, where buttons and runner bars may be re-used.
- Slow and fast melting speed button.
- Continuous-reading control and stabilization of the temperature in the range from 800 to 2000° C.
- Equipped with motor acceleration regulator to control the metal flow to the ring.
- Fitted with two crucible holder carriages allowing the use of standard or large crucibles.
- Built-in cooling system.
- Equipped with powerful vacuum pump.
- Use of crucibles in ceramic, coated ceramic, graphite or sintered graphite

**Starting Kit:** Set of stainless steel rings - Universal rubber sprue former - Crucible carriage for small crucibles - Small and large crucible for titanium - Crucibles for precious and non-precious alloys - Ceramic stirring rod - Safety goggles.

3-phase 380 Volts - 50 Hz

M10H3

3-phase 220 Volts - 60 Hz

M10H201

Features and technical data	NEUTRODYN EASYTI HD	NEUTOR TI
Max casting capacity	5 cc precious - 15 cc non-precious titanium 30 g	20 cc precious - 35 cc non-precious titanium 70 g
Casting time	30 g Cr-Co - 60" • 30 gr Ti - 90"	30 g Cr-Co - 45" • 36 g Ti - 45" (C 35 Ti)
Max consumption	2,4 kW	6,5 kW
Width	63 cm	77 cm
Depth	90 cm	108 cm
Height	92 cm	98 cm
Net weight / Gross weight	160 kg / 195 kg	352 kg / 395 kg
Available crucibles	C15 N - C15 R - C15 PLUS - C15TI C15TIP - CG5XD - CGV5	C15 N - C15 R - C15 PLUS - C15TI - C15TIP - CG5XD CGV5 - C35N - C35R - C35 PLUS - C35TI C35 TIP - CG20 - CGV20
SERVICE TABLE	optional - code <b>T09AD</b>	optional - cod. <b>T09AD</b>



In this picture the difference between casting the same alloy in natural atmosphere and casting in inert atmosphere is evident.



### From the exception to the reliability

The experience achieved in the dental labs joined to a constant and accurate research developed for more than 15 years, allowed us to improve the performance and reliability of new materials like the crucibles coating and investment powder for titanium.

The titanium can now be used for all prosthesis: crown and bridge, removable implants, framework, in conjunction with resin, composite and porcelain.

Titanium is the only metallic prosthetic material with high biological inertia; in contact with implants it does not generate oral galvanic phenomena.

Titanium is excellent for aged patients and for people subject to denture sore: because of its very low conductivity, tissues are not subject to thermal shocks consequent to ingestion of iced or hot food-stuff. Being the titanium transparent to X-ray it is not necessary to remove crown and bridges for root inspection. This property, joined to its inertia to REM and TAC emissions, makes titanium the only material not interfering with post-traumatic examination. The **EASYTI SYSTEM**® is recognized as a complementary method to the implants technology.



**TICOAT S+L** - Investment particularly designed to produce any kind of titanium prosthesis. Available in 5 Kg powder packs (10 bags of 500 gr. each), with a fluid bottle of 770 cc capacity.

**TICOAT SUPER** - After years of researches now our magnesium-base investment is available, granting high precision and extremely fine castings. Excellent for fixed prosthesis and when very smooth surfaces are required. Available in 1 kg can. **Mix just with distilled water!**

TICOAT S+L 5 kg + 770 cc. liquid	70259	TICOAT Liquid 770 cc	70258	TICOAT SUPER 1 kg	70359
----------------------------------	-------	----------------------	-------	-------------------	-------



**C15Ti - C35Ti** - regular and large crucibles for titanium castings; they can be used one or two times for the titanium and afterwards for Cr-Co or other non precious metal.

**C15TiP - C35TiP** - regular and large crucibles for titanium castings; they may be used up to 5 times with titanium and then afterwards with Cr-Co or other non precious metals.

C15Ti (6 pcs. pack)	60111C02	C15TiP (6 pcs. pack)	60123C01
C35Ti (6 pcs. pack)	60135C01	C35TiP (6 pcs. pack)	60423C01
C15Ti (25 pcs. pack)	60111C25	C15TiP (25 pcs. pack)	60123C25
C35Ti (25 pcs. pack)	60135C25	C35TiP (25 pcs. pack)	60423C25



**POLISHTI** - Special kit built-up to properly finish the titanium prosthesis. Particularly recommended to the beginners. Including 300 gr TiPASTE.

**TiPASTE** - TiPASTE keeps titanium shiny finished and brilliant and does not tarnish even after long time.

POLISHTI	71400	TiPASTE (3 pc of 300 gr. each)	71500C01
----------	-------	--------------------------------	----------



**Ti WIRE** - Titanium wire for laser welding.

Supplied in dispenser of 2 m; available Ø 0,25 - 0,5 - 0,6 - 0,8 mm.

Ti WIRE Ø 0,25 mm - 2 m	72050025	Ti WIRE Ø 0,5 mm - 2 m	72050005
Ti WIRE Ø 0,6 mm - 2 m	72050006	Ti WIRE Ø 0,8 mm - 2 m	72050008



### GALILEO

**The powerful dental laser: small, nice, ergonomic**

70 joule effective power in reduced space. Powerful cooling system, granting continuous work.

Friendly installation, maintenance and use. Wide colourful display for an immediate visualization.

Easy-reading software for beginners. Up to 50 programs storage. Customized waves calibration with graphic display or through histograms. Automatic sleep mode to save energy. Software updating through USB connection. Service table (upon request).

(For more details see pages 4-5)



### KERASMART 200

Ceramic furnace designed to be used with titanium as well as with any dental alloy.

The special software allows after casting heat treatments in inert atmosphere.

Combined cycles with natural - vacuum - argon atmosphere.

For safety and privacy, data also can be stored on smartcards keeping up to 15 cycles each.

(For more details see pages 12 and 13).

# Laser welding

## The compact laser welder with the best performances/price ratio.

- 70 joule effective power in reduced space to weld any shape of any alloy, titanium included, thanks to the argon protection in the welding area.
- High efficiency cooling granting continuous work.
- "Plug & play" installation, friendly maintenance and use.
- So compact that can be located on any lab table.
- Strong and maintenance free (change of the water once a year!).
- Wide colourful display with easy reading for beginners.
- Encoder inside the welding room to quickly modify.
- Storage up to 50 welding programs.

**NEW**



### Pulse shaping.

Reliable and safe welding can be obtained only when, beside the traditional parameters (power, spot diameter, time), also the pulse shaping can be designed in relation to alloy, thickness and shape of the item to be welded.  
20 stored and 10 free for individual design.

### Pulse filling program.

To avoid tensions of the metal mass, it is possible to design a special shape containing several micro-pulses in one single shot.

### Sleep mode.

Automatic "sleep mode" after 20' inactivity to save precious energy and increase all GALILEO components life.

### Cold lighting

through 3 white led panels ensuring "no-shadow" daylight effect to prevent eye stress due to long-time work

**Upgrade** to the latest software release through USB connection **Stereomicroscope** with binocular 10X for an extreme precision welding even close to resin and ceramic.

**Optical filter** against UV and laser radiation.

**Argon gas** protection easy and effective thanks to direction and flowing regulations.



# Galileo

X48A4	GALILEO (230V - 50/60Hz)
ACCTEL20 KIT	CAMERA WITH LCD SCREEN
ACCSTE02	UPGRADE LEICA MICROSCOPE
T46A0	SFA (LIGHTED SERVICE TABLE)



Laser source	Nd:YAG (1064 nm)
Pulse energy max.	70 J
Average power	70 W
Peak power	7 kW
Pulse width	0.5 – 20 ms with steps of 0.5 ms
Spot diameter	0.2 – 2.0 mm automatic regulation with steps of 0.1 mm
Pulse frequency	Single shot or up to 20 pulse/sec dynamically controlled (1÷20 Hz)
Cooling circuit	Integrated air-to-water with automatic sleep mode and deionizer filter
Fumes suction	Integrated
Protection gas supply	Injection with flexible nozzle, electronically controlled. Possibility to regulate time and intensity of the flux
Compressed Air gun	Internal mobile nozzle for air cooling
Aiming system	Webbed eyepiece + laser pin
Microscope	Acromatic stereomicroscope, focal 120mm. Optical protection against UV and laser radiation
Working area lighting	Cold light source (led)
Pulse shaping	20 standard shapes + 10 shapes which can be programmable by the user Custom shapes completely adjustable throughout the graphic display of the machine
Pulse filling	With duty cycle adjustable by the operator
Program memories	50 programmes with all the working parameters
Parameters setting	Electronically, throughout a rotary encoder placed into the working chamber. All the working parameters are shown on a wide colourful graphic display
Autodiagnosis System	Automatic with warnings on display
Power Supply	230V (± 10%) single phase; 50/60Hz, 10A
Videocamera + LCD screen	Optional: videocamera on trinocular tube + LCD flat screen
Service table SFA	Optional lighted service table
PC connection	USB
Flexholder	Optional micrometric adjustable model holder
Size	500 (L) x 515 (A) x 660 (P)
Weight	65 Kg



Gold bridge before welding



Welding with alloy addition



The bridge ready



#### FLEXHOLDER MICROMETRIC ADJUSTABLE HOLDER

One of the most important conditions to obtain perfect welding results is related to precise focus settings. With adjustable flexholder, welding will result extremely precise.

65200122

Flexholder

#### WELDING Cr-Co WIRE

With GALILEO it is possible to weld using as soldering material Chrome Cobalt wire having the same characteristics of the Cr-Co itself. available in sizes Ø 0,35 and 0,50 mm.

#### WELDING Ti-Wire

GALILEO also allows to weld Titanium using grade 1 Titanium wire. This wire is available in sizes Ø 0,25 - 0,50 - 0,60 - 0,80 mm.

Cr-Co Wire and Ti Wire are supplied in dispensers containing 2 m wire each.

72000035	Cr-Co Wire ø 0,35 mm	72000005	Cr-Co Wire ø 0,50 mm
72050025	Ti Wire ø 0,25 mm	72050005	Ti Wire ø 0,50 mm
72050006	Ti Wire ø 0,60 mm	72050008	Ti Wire ø 0,80 mm



# Induction casting



## MILLENNIUM – AURUM 2 – SMALLCAST

MILLENNIUM, AURUM 2 and SMALLCAST are induction casting machines for all alloys, except titanium. SMALLCAST has been designed for the labs where the room is a problem or the freight costs should be minimized. SMALLCAST is reduced in height to be placed on a table or on a suitable stand and has a separate cooling water system (optional) or can be connected to the water tap through a water softener (optional).

MILLENNIUM, AURUM 2 and SMALLCAST are available in the "S" version (without temperature control) and in the "R" version (with temperature control).

- Casting of precious and non-precious metals.
- Self-diagnostics of circuits and safety devices.
- Manual and fully automatic casting cycle.
- Casting power setting feature.
- Continuous-reading control and stabilization of the temperature in the range from 800 to 2000°C (on "R" models).
- Powered movement of the casting coil.
- Manual or automatic centrifugation control.
- Equipped with motor acceleration regulator to control the metal flow to the ring.
- Use of crucibles in ceramic, coated ceramic, graphite or sintered graphite
- MILLENNIUM and AURUM 2 are supplied with built-in water cooling system.

Power supply	MILLENNIUM S	MILLENNIUM R	AURUM 2 S	AURUM 2 R	SMALLCAST S	SMALLCAST R
230 Volts - 50 Hz	M37B4	M37A4	M49B4	M49A4	M38B4	M38A4
230 Volts - 60 Hz	M37B401	M37A401	M49B401	M49A401	M38B401	M38A401

MILLENNIUM S HD and MILLENNIUM R HD are equipped with a new high efficiency solid state generator with EBST (**Electronic Board Selected Tolerance**), granting heavy duty cycle work up to 40 continuous castings.

Power supply	MILLENNIUM S HD	MILLENNIUM R HD
230 Volts - 50 Hz	M37B45HD	M37A45HD
230 Volts - 60 Hz	M37B46HD	M37A46HD



Features and technical data	MILLENNIUM	AURUM 2	MILLENNIUM HD	SMALLCAST
Max. casting capacity	5 cc precious - 15 cc non precious	20 cc precious - 35 cc non precious	5 cc precious - 15 cc non precious	5 cc precious - 15 cc non precious
Casting time	30 gr Cr-Co 60"	30 gr Cr-Co 60"	30 gr Cr-Co 60"	30 gr Cr-Co 60"
Max. consumption	2,4 kW	2,4 kW	2,4 kW	2,4 kW
Width	64 cm	64 cm	64 cm	64 cm
Depth	55 cm	55 cm	55 cm	55 cm
Height	88 cm	88 cm	88 cm	52 cm
Net weight / Gross weight	93,5 kg / 106 kg	93,5 kg / 106 kg	93,5 kg / 106 kg	78 kg / 92 kg
Available crucibles	C15 N - C15 R - CG5XQ - CGV5	C35N - C35R - CG20XQ - CGV20 Whitelake C15N-C15R-CG5XQ-CG5	C15 N - C15 R - CG5XQ - CGV5	C15 N - C15 R - CG5XQ - CGV5
Max cylinder sizes	Ø 80 x 80 mm	Ø 80 x 80 mm	Ø 80 x 80 mm	Ø 80 x 80 mm
<b>Starting kit</b>	<b>Set of stainless steel rings - Universal rubber sprue former</b>			
	<b>Crucibles for precious and non-precious alloys - Ceramic stirring rod - Safety goggles</b>			
ARGON DEVICE	optional - code D01Y0	optional - code D01Y0	optional - code D01Y0	optional - code D01Y0
SERVICE TABLE	optional - code T09A0	optional - code T09A0	optional - code T09A0	optional - code T09A0

**NEW! - Adjustable cylinder holder** depending on the diameter and the height of the cylinder in use. Easy cylinder setting to the corresponding crucible nozzle. Fitting any cylinder size, up to Ø 80 x 80 mm. Locker device to keep the cylinder on site even when the maximum spin is applied.



## aurum 2

THE SMALL "BIG"  
CASTING MACHINE WITH EBST  
(**Electronic Board Selected Tolerance**)

Aurum 2 is purposely designed for large sized chrome dental labs. The power needed is 2,4 kW only so that it can be installed in a shop non electrically supplied as a factory!



*The use of a large crucible allows to melt the sprue buttons with pins thus reducing the unpleasant job of cutting, saving precious time.*





## Ephestos: Vacuum pressure induction casting machine

Ephestos, the new vacuum pressure induction casting machine. Small, nice, ergonomic, powerful and user friendly. Allows the easy casting of precious and non precious alloys. Thanks to induction, the mass of metal is melted in any part, reaching a liquid status which allows the easy flowing of the mass from the crucible to the ring, thus avoiding incomplete castings and rounded edges. Automatic positioning of the working chamber in casting position, and continuous view of the crucible. Automatic change to the casting position, and afterwards back to the rest position. Friendly installation, maintenance and use. Use of traditional (up to dia. 80 x 90 mm), or free expansion cylinders.

- Casting of any dental alloy (titanium excluded)
- Continuous reading control and stabilization of the temperature in the range from 800 to 2000°C
- Easy positioning of any kind of casting ring, up to Ø 80 x 90 mm (stainless steel - free expansion - conical or cylindrical or square shape)
- Cooling through direct connection to the water tap ("N" version) or through a closed independent system ("W" version)
- Possibility to melt with natural or argon pressure
- Adjustable vacuum values
- Manual or completely automatic casting cycle
- Compressed air requirement: 7 bar

**Code T46E0**

SFE Service lighting table (upon request)

Power supply	EPHESTOS N	EPHESTOS W
230 Volts - 50/60 Hz	M46B4	M46A4

Features and technical data	EPHESTOS N	EPHESTOS W
Power		2860 W
Current		13 A
Voltage		230 V
Width		70 cm
Depth		45 cm
Height		55 cm
Net Weight / Gross Weight	65 kg / 85 kg	80 kg / 100 kg
Available crucibles		C18E - CG7E
Casting chamber capacity		4 lt
Max casting temperature		2000°C
Casting pressure		3 Bar
2 Vacuum levels		400 mm Hg; 650 min Hg
Casting speed		Adjustable on 8 levels
Melting speed		Adjustable on 8 levels
Casting time		Adjustable on 8 levels (min: 10 sec / max: 60 sec)
Casting rings		Max Ø 80 mm x 90 mm / Min. Ø 30 mm x 30 mm
Casting rings centering		Auto centering also for free expansion moulds
Casting cycle		Manual or automatic
Auto diagnosis		Integrated for all the functions
Starting kit		Set of stainless steel rings Universal rubber sprue former 1 crucible per type - Ceramic stirring rod Safety goggles - Specific crucibles long
Optional		
Vacuum pump 5S		230 V - 50/60 Hz (code 508A4)



## VACUUM PUMP 5S

We recommend to use EPHESTOS exclusively with the vacuum pump 5S, thus avoiding any damage arising from an unfit pump. (For more details see page 13)

**Code 508A4**

# Centrifuges



## CENTRECAST

Centrelcast is the centrifugal electric machine where the most advanced technology meets the most pleasant and ergonomic design. Due to its reduced sizes, CENTRECAST can be placed on a lab table, or inside a suitable sliding drawer, or on a stand furniture supplied as optional upon request.

Thanks to the perfect balancing system, the rotation is extremely silent without vibrations, thus requiring no special fastening to the working stand where it is placed.

Adjustable cylinder holder depending on the diameter and height of the cylinder in use. Easy cylinder setting to the corresponding crucible nozzle. Fitting any cylinder size from the 1X up to the 9X as well as free expansion moulds in the current shapes and sizes. Locker device to keep the cylinder on site even when the maximum spin is applied.

The arm is driven through a geared electric motor, on which it is possible to select:

- 10 arm acceleration rates
- 10 rotation speeds starting from 200 rpm up to 700 rpm
- the centrifugal time up to 99 sec

### Starting kit:

Set of stainless steel rings - Universal rubber sprue former - Crucible U12

### SFC - CENTRECAST Service Furniture

Code T05C0

Power supply	CENTRECAST
230 Volts - 50/60 Hz	C05B4
110 Volts - 60 Hz	C05B1
Features and technical data	CENTRECAST
Max consumption	660 W
Width	54 cm
Depth	54cm
Height	35 cm
Net weight/Gross weight	37 kg / 57 kg



10 rotation speed rates from 200 up to 700 rpm



10 arm acceleration rates



Centrifugal time until 99 sec.

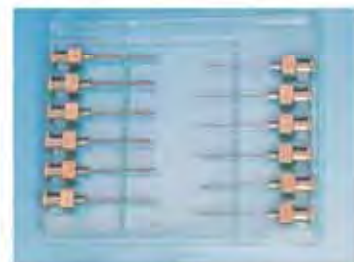

**WK8 soldering kit** (adapter + 12 assorted needles)  
transforming BP8 in miniflame as described on page 15.



## ERGOPIPE

is an ergonomic magnetic holder for BP8 blowpipe. Can be located in the most convenient position to the operator.



## BP8

gas/oxygen blowpipe for dental lab with universal multi-flame nozzle, for melting precious and non precious alloys.



Blowpipe bp8	Code 64000600
ErgoPIPE holder for bp8	Code 64000650
Wk8 welding kit for Bp8	Code 64000630



**C15N**  
Ceramic crucible for standard mix of non-precious alloys.  
6 pcs. 60100C01  
25 pcs. 60100C02

**C15R**  
Ceramic crucible with silicon nitride coating for non-precious alloys.  
6 pcs. 60107C01  
25 pcs. 60107C02

**C15PLUS**  
High quality ceramic crucible for non-precious alloys.  
6 pcs. 60103C01  
25 pcs. 60103C02

**C15TI**  
Ceramic crucible with coating for titanium.  
6 pcs. 60111C02  
25 pcs. 60111C25

**C15TIP**  
Long-life ceramic crucible with coating for titanium.  
6 pcs. 60123C01  
25 pcs. 60123C25



**C15NPR**  
Ceramic crucible for standard mix of non-precious alloys. Long nozzle.  
6 pcs. 60700C01  
25 pcs. 60700C02

**C15RPR**  
Ceramic crucible with silicon nitride coating for non-precious alloys. Long nozzle.  
6 pcs. 60707C01  
25 pcs. 60707C02



**C35N**  
Ceramic crucible for standard mix of non-precious alloys.  
6 pcs. 60400C01  
25 pcs. 60400C02

**C35R**  
Ceramic crucible with silicon nitride coating, for non-precious alloys.  
6 pcs. 60407C01  
25 pcs. 60407C02

**C35PLUS**  
High quality ceramic crucible for non-precious alloys.  
6 pcs. 60403C01  
25 pcs. 60403C02

**C35TI**  
Ceramic crucible with coating for titanium.  
6 pcs. 60135C01  
25 pcs. 60135C25

**C35TIP**  
Long-life ceramic crucible with coating for titanium.  
6 pcs. 60423C01  
25 pcs. 60423C25



**CG6XQPR**  
Crucible with isostatic graphite lining, for precious alloys, long nozzle.  
6 pcs. 60797C06  
25 pcs. 60797C25



**CG5XQ**  
Crucible with isostatic graphite lining, for precious alloys.  
6 pcs. 60200C01  
25 pcs. 60200C02



**CGV5**  
Crucible in vitreous graphite + C5 container with cover, for precious and Palladium alloys.  
6 pcs. 60335C00  
12 pcs. 60335C12



**CG20XQ**  
Crucible with isostatic graphite lining, for precious alloys.  
6 pcs. 60510C01  
25 pcs. 60510C02



**CGV20**  
Crucible in vitreous graphite + ceramic container C20 with cover, for precious and Palladium alloys.  
6 pcs. 60505C01  
12 pcs. 60505C12



**U12**  
Ceramic crucible for MOTORCAST, TABYCAST and CENTRELCAST  
6 pcs. 60601C01  
25 pcs. 60601C02



**CERAMIC STIRRING RODS**  
10 pcs. 69100C01  
100 pcs. 69100C02



**C18E**  
Ceramic crucible for standard mix of non-precious alloys, for EPHESTOS  
6 pcs. 67050C06



**CG7E**  
Crucible with isostatic graphite lining, for precious alloys, for EPHESTOS.  
6 pcs. 67100C06

## LEGEND

- C:** ceramic
- N:** regular mixture
- R:** silicon nitride coating
- PLUS:** high quality mixture
- TI:** coated for single use titanium
- TIP:** coated for multiple use titanium
- G:** graphite
- CG:** graphite lined crucible
- XQ:** isostatic graphite
- GV:** vitreous or sintered graphite
- CGV:** vitreous graphite with ceramic container
- 15:** capacity in cc (about 40 gr non precious)
- 35:** capacity in cc (up to 100 gr non precious)
- 5:** capacity 5 cc (up to 80 gr precious)
- 6:** capacity 6 cc (up to 80 gr precious)
- 20:** capacity 20 cc (up to 200 gr precious)

## THE CERAMIC

Our ceramic crucibles are manufactured with high selected mixtures, without impurity or elements polluting or spoiling the alloy. Choose the most suitable for your non precious alloy!

## THE GRAPHITE

The graphite we use for our crucibles is exclusively of high selected isostatic type. This means a constant quality and high compactness to ensure a very long life with excellent casting quality.

## THE VITREOUS GRAPHITE

The vitreous graphite, also called sintered graphite, is obtained from sintering process, originally designed for high percentage palladium alloys, are more and more used with precious alloys, to obtain excellent castings specially for dental porcelain

## FAKE CRUCIBLES

There are on the market many retailers and/or so called distributors selling fake "MANFREDI" crucibles.

These crucibles very often are manufactured with cheap and low quality materials that can pollute the alloy or destroy the machine circuitry. In case of use of fake crucibles the guarantee automatically expires and we are not responsible for any inconvenience. All original crucibles are marked MANFREDI or SAED and are supplied in cartons or boxes with our logo.

# Pre-heating



The MANFREDI burnout furnaces for rings, whose design is based on criteria acquired during more than 70 years of activity and experience, are today equipped with the most updated and reliable control and programming systems, while insuring the utmost ease of use.

## Heating muffle

It consists of 4 heating plates, whose profile:

- Enlarges the radiant surface with a consequent increase in the thermal yield.
- Insures a more even heat distribution.
- Facilitates the removal of waxes immediately after they melt, thus avoiding their burning inside the ring.



**External case** Completely made of stainless steel: resistant to corrosion, therefore almost indestructible.

**Door** Lined with high-insulation refractory material, which avoids any loss of heat outwards.

**Door movement** Horizontal parallelogram moving type:

- Any accidental contact of the operator with the hot surfaces is avoided.
- The door movement does not jam, thanks to its self-lubricating materials.

## Safety

In order to prevent even the most careless of accidents, the MANFREDI furnaces are provided with:

- Power cut-out to switch off power from the plates when the door is opened.
- Double-pole fuses.

Features and technical data	L7C	L7B	L9C	L9B
Overall dimensions (cm)				
Width x Depth x Height	27x41x48	27x41x48	33x57x55	33x57x55
Heating chamber (cm)				
Width x Depth x Height	12x19x10	12x19x10	16x30x15	16x30x15
Net weight / Gross weight (kg)	24/26	24/26	40/45	40/45
Max. consumption (watt)	1760	1760	2990	2990
Max. temperature (°C)	1000	1100	1000	1100
Capacity in rings	5 medium	5 medium	10 large	10 large
Fume outlet	pipe N	pipe N	pipe N	pipe N
EXFT fan/timer exhaust	optional	optional	optional	optional
Code 230 V-50/60 Hz	F15N4	F15B4	F16N4	F16B4
Code 110V-50/60 Hz	F15N1	F15B1	not available	not available

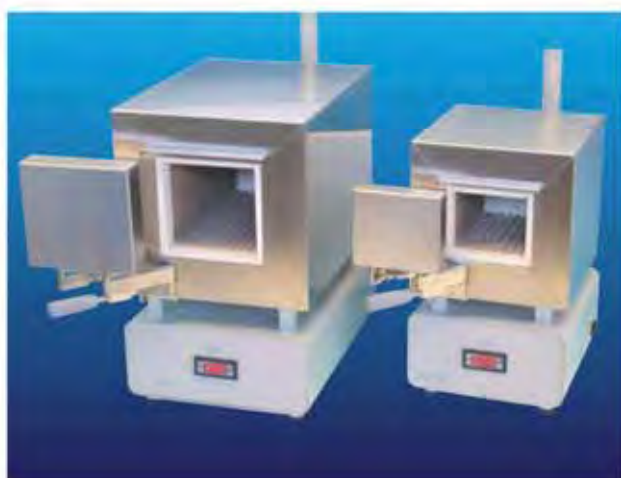

## L7C - L9C

This series of burnout furnaces, though being very economically priced, insures absolute reliability and practicality of use.

These burnout furnaces are especially recommended for beginners, as backup furnace and when using fast investments.

Direct rise to the set temperature which, once reached, is indefinitely maintained.

**Instruments:** Switch-On push-button - Digital self-adjusting pyrometer.



Power supply	L7C	L9C
230 Volts - 50 / 60 Hz	F15N4	F16N4
110 Volts - 50 / 60 Hz	F15N1	Not available



## L7B - L9B

**New! The best rate quality/price!!!**

### Heating cycle

Up to 100 hours delay of starting.  
Programming of temperature raising rate °C/min.  
Continuous holding of the final temperature, once reached.

**Instruments:** Switch-On push-button  
Computerized parameter setting.



Power supply	L7B	L9B
230 Volts - 50 / 60 Hz	F15B4	F16B4
110 Volts - 50 / 60 Hz	F15B1	Not available

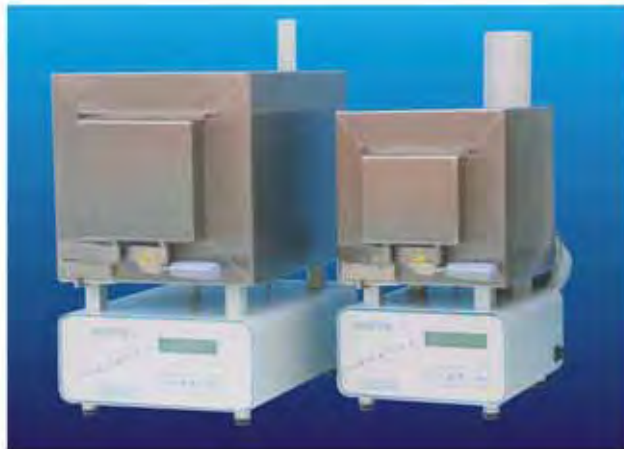

## WARMY 7 - WARMY 9

### The Manfredi most successful furnaces!

Easy and smart 4 key-board to program the heating cycles.

RUN/ABORT keys to start or stop the cycle.

7 leds displaying the cycle progress both during the programming and the execution.

**Configurations:** (set) Date & clock - Language - °C/°F - Temperature calibration.

**Heating cycles settings:** Up to 10 cycles storage. 4 choices of heating cycle starting: immediate - delayed with timer up to 100 hours - delayed with clock on starting - delayed with clock programmed on heating cycle end.

Up to 3 independent temperature rates (°C/min or °F/min) . Up to 3 temperature steps (°C or °F). Increasing and/or decreasing steps (i.e. for titanium).

Independent timing of temperature steps. Switching on/off of the exhaust fan at every step of the cycle (on models "V"). Acoustic and optical cycle end alarm. ON/OFF option after alarm.

All programs can be modified during the execution, Displaying the time remaining to the end. The cycle settings are indefinitely stored until re-programmed. Automatic restart after current black-out. Failure self diagnostic program.

**Instruments:** Main switch - 4-key board - 7 led track on the diagram panel - Alphanumeric display showing all parameters both in programming and during execution.

Features and technical data	Warmy 7N	Warmy 7V	Warmy 9N	Warmy 9V
Overall dimensions (cm)				
Width x Depth x Height	28x43x56	28x54x60	34x59x62	34x70x66
Heating chamber (cm)				
Width x Depth x Height	12x19x10	12x19x10	16x30x15	16x30x15
Net weight / Gross weight (kg)	27/31	30/34	44/49	47/52
Max. consumption (watt)	1760	1760	2990	2990
Max. temperature (°C)	1100	1100	1100	1100
Capacity in rings	5 medium	5 medium	10 large	10 large
Code 230 V-50/60 Hz	F44A2	F44B2	F45A2	F45B2
Code 110V/-50/60 Hz	F44A1	F44B1	F45A1	F45B1

## SMOKLEAN fume & steam catalyzer

NEW



Cod. V00A71/V00A72

### SMOKLEAN

is a unit designed to destroy the smokes, steams and vapours created during the casting flasks burnout cycle.

smoklean can be fitted on any Manfredi burnout oven equipped with a rear fumes escape.

**smoklean B** is equipped with a power box to work joined to the furnaces equipped with timed program board. The box is equipped with magnetic feet so it can be fixed on the rear of the burnout base.

**smoklean T** is equipped with a timed plug to be fit to the power socket. Smoklean T is suggested for the furnaces without timed program board.

To keep the environment totally clean, smoklean must be connected to a proper chimney



Features and technical data	Smoklean B	Smoklean T
230 Volts - 50/60 Hz - 600 W	V00A71	V00A72
110 Volts - 60 Hz - 600 W	V00B71	V00B72

# Ceramic furnace

## KERASMART 200

**KERASMART 200** is an absolutely reliable ceramic furnace, very easy to program and use.

**KERASMART 200** can be used also with argon atmosphere as required by the most up-to-date titanium technique. In the quartz muffle, the uniform heating distribution insures a continuously high level prosthesis quality.

The temperature rising rate in the muffle is controlled by microprocessors, which insure finest control up to 150 °C/min.

Any possible voltage or room temperature changes are compensated by the integrated control system.

The lift-plate supporting a highly-insulation firing tray rotates freely.

The lift rises and lowers with continuous smooth steps in order to avoid any shock or vibration.



Features and technical data	kerasmart 200
Overall dimensions (cm)	
Width x Depth x Height	25x36,5x49
Keyboard dimension (cm)	
Width x Depth x Height	25x13,5x4
Quartz muffle	
Diameter (cm)	9,5
Lift down height (cm)	6,7
Lift up height (cm)	4,5
Net / Gross weight (kg)	25 / 31
Max. consumption (watt)	1260
Max temperature (°C / °F)	1200 °C / 2192 °F
Purchase code	
230 V - 50/60 Hz	F44A2
110 V - 50/60 Hz	F44A1

- Easy and smart mobile keyboard suitable for more kerasmart units
- Real time cycle status graphic and digital on wide LCD screen with progress track
- Up to 15 cycles can be stored in each personal smartcard, in order to be used with different Kerasmart
- Configurations: (set)
  - Date & clock - Language - °C/°F - temperature calibrations
- Storage up to 200 cycles on the CPU (including 10 idle and night cycles) with backup on the smartcard
- Timing min / sec or hours / min
- Air, vacuum, argon programmable at each step
- Up to 3 temperature setting on each cycles
- Programming of heating cycle with increasing and / or decreasing steps
- Acoustic and optical alarm at heating cycle end
- Heating cycle programs can be modified during the execution
- Automatic restart after current black-out
- Emergency manual vacuum release & lift-down plate
- Failure self diagnostic program

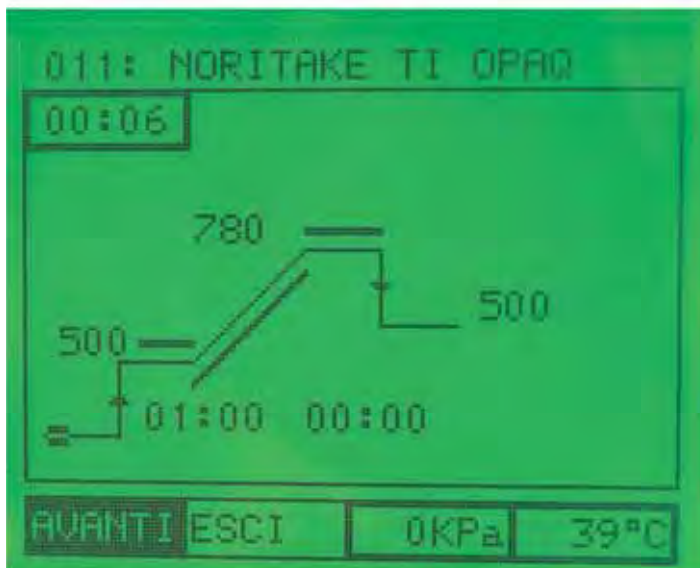

Code 80009630 (6 pcs.)



### VACUUM PUMP 5S

Since kerasmart 200 is driven by electronic boards, we suggest to use it exclusively with the vacuum pump 5S, thus avoiding any damage arising from an unfit pump.

5S is a high quality silent and reliable vacuum pump.

Fit a suitable dust filter when using it with plaster mixers.

Features and technical data	Vacuum pump 5S
Overall dimensions (cm)	
Width x Depth x Height	14x35x24
Net / Gross weight (kg)	11 / 12
Max. consumption (watt)	370
Purchase code	
230 V - 50/60 Hz	508A4
110 V - 50/60 Hz	508A1

# Welding



## ODONTOWELD

ODONTOWELD is the multi-purpose welder capable of solving a lot of spot-welding and soldering problems that arise daily in a dental laboratory.

ODONTOWELD is designed both for spot-welding and brazing (welding with addition of solder).

ODONTOWELD is to be considered as two machines in one unit: with the central commutator set on right side, pressing on the footswitch ODONTOWELD operates as **spot-welding**. The accuracy is granted by a 12-position power regulator and a 12-position timer (**blue marked side**). Setting the central commutator on left side, acting on the pedal rheostat, ODONTOWELD operates the **brazing** (green marked side).



### Standard kit of accessories:

- Spot-welding electrode type T with head.
- Spot-welding electrode type U with head.
- Spot-welding electrode type V.
- Spot-welding electrode type Z.
- Pair of **hand cables** to spot-weld on the model directly, with electrodes type S.
- 1 Holding **pincer** for brazing.
- Brazing electrode in **copper-plated carbon type N** with head.
- Brazing carbon electrode type P with head.
- **Carbon-holding cable** for brazing with copper-plated carbon electrode type N.
- Allen wrench.

230 Volts - 50 / 60 Hz

Q01A4

### Additional orthodontic accessories:

The following optional accessories allow ODONTOWELD to carry out orthodontic spot-welding works:

- 8 spot-welding electrodes type A - B - C - D - E - I - L - M with head.
- Wire hardening device.
- Pincer to spot-weld on the model directly.

Set of 8 electrodes with head for orthodontics	Q02A0
Wire hardening device	Q03A0
Pincer to spot-weld on the model directly	Q04A0



### Features and technical data

Features and technical data	ODONTOWELD
Max consumption	880 W
Width	27 cm
Depth	26 cm + 11 cm hands holder
Height	22 cm
Net weight / Gross weight	20 kg / 22 kg

## ODONTOWELD ORTHO

ODONTOWELD ORTHO is suitable for orthodontics laboratories with large output where, in addition to spot-welding, also the brazing has to be carried out.

### Standard kit accessories:

- Brazing electrode in copper-plated carbon type N with head.
- Brazing carbon electrode type P with head.
- 8 spot-welding electrodes type A - B - C - D - E - I - L - M with head.
- Pincer to spot-weld on the model directly.
- Wire hardening device.
- Allen wrench.

230 Volts - 50 / 60 Hz

Q05A4

### Features and technical data

Features and technical data	ODONTOWELD ORTHO
Max consumption	880 W
Width	27 cm
Depth	26 cm + 11 cm hands holder
Height	22 cm
Net weight / Gross weight	19 kg / 21 kg







## ORTHOWELD

- ORTHOWELD is a powerful spot-welder, specifically designed for both orthodontic thin and thick spot-welding operations.
- Spot-welding, controlled by means of a foot pedal, may be accurately calibrated with 12 power levels and 12 time settings.
- The ergonomic hand-rest makes the positioning of the parts to be easier spot-welded.

### Standard kit of accessories:

- 4 spot-welding electrodes type A – B -I - L with head
- Allen wrench.

230 Volts - 50 / 60 Hz	Q06AA
110 Volts - 50 / 60 Hz	Q06A401



### Optional accessories:

- Pincer to spot-weld on the model directly.
- Electrode with head type C.
- Electrode with head type D.
- Electrode with head type E.
- Electrode with head type M.

Pincer to spot-weld on the model directly	Q04A0
Electrode with head type C	80003762
Electrode with head type D	80003764
Electrode with head type E	80006766
Electrode with head type M	80003768



Features and technical data	ORTHOWELD
Max consumption	880 W
Width	27 cm
Depth	26 cm x 11 cm hands holder
Height	22 cm
Net weight / Gross weight	19 kg / 20 kg



## MINIFLAME

Rotating refractory propane gas - oxygen blowpipe for soldering. Including torch, nozzle and 12 assorted needles.

Code 64000660

## RTOSOLD

RTOSOLD is a rotating refractory fixed to a sturdy base, which insures higher stability. Essential to facilitate the welding operations. ROTOSOLD is equipped with a powerful magnetic device, which locks any mount intended for supporting the parts to be welded (as CRABBY) or the model (as FIXIT).

Code Q08A1

## CRABBY

CRABBY is an articulated support. It is equipped with 2 clamps allowing an easy and ergonomic positioning of the parts to be welded.

Owing to its metal base, CRABBY keeps firmly locked to the rotary table ROTOSOLD.

Code Q08C1

Features and technical data	CRABBY
Net weight	0,500 kg



## FIXIT

Adjustable and articulated support for models.

Owing to its metal basis, FIXIT keeps securely locked to the rotary table ROTOSOLD.

Code Q08B1

Features and technical data	FIXIT
Net weight	0,480 kg



# Projecting & Milling



Code P100A

**ABLE**  
Surveyor with one (1) straight arm, ideal for parallel positioning of attachments.



Code P100B

**BRAVO**  
Surveyor with one (1) swivel arm and central articulated joint, ideal for prosthesis framework design.



Code P100C

**CHAMPION**  
Surveyor with one (1) arm and one (1) swivel arm with central articulated joint, ideal for prosthesis framework design and parallel positioning of attachments.



Code P10FA

**FAST A**  
Milling surveyor with double-articulated arm for the moulding and positioning of attachments, supporting any kind of turbine engine or micromotor, with vertical micrometric adjustment. Equipped with axial milling device.



230 Volts - 50 Hz P10FB

**FAST B**  
Milling surveyor with double-articulated arm for the moulding and positioning of attachments and supporting any kind of turbine engine or micromotor, with vertical micrometric adjustment. Equipped with axial milling device. Accessories store with low-voltage halogen lamp and air supply.

**ALL SURVEYORS ARE EQUIPPED WITH THIS KIT OF ACCESSORIES:**

- Model-holder FIXIT.
- 1 wax chisel.
- 1 scanning needle probe.
- 3 undercut gauges.
- 1 carbon marker holder.
- 1 Ø 3 mm Collet.
- 1 Ø 2,5 mm Collet.



Features and technical data	ABLE	BRAVO	CHAMPION	FAST A	FAST B
Width	19 cm	19 cm	19 cm	19 cm	19 cm
Depth	20 cm	20 cm	20 cm	20 cm	28 cm
Height	31 cm	31 cm	31 cm	40 cm	40 cm
Net weight / Gross weight	4 kg / 4,5 kg	4 kg / 4,5 kg	4,5 kg / 5 kg	6 kg / 6,5 kg	8 kg / 8,5 kg



milling unit

## Fresatech

**Quality milling and drilling with the highest precision.**

Complete milling-machine with pantograph arm, miller/vertical/parallelometer/attachmant placing, with:

- 1.500/30.000 rpm micromotor with internal light
- On/off motor switch pedal
- Power puppy with rpm and reverse display
- Tilting model-table with electromagnet

Freedom of movement with high precision mechanical adjustment, vertical and micrometric

Features and technical data	FRESATECH
Width	25 cm
Depth	25 cm
Height	40 cm



No shade internal light for a perfect visibility.



OPTIONAL:  
Air system kit



## UNDERMILL

When a precision milling on palatal and lingual areas on plaster or acrylic models is required, **Undermill** is the most reliable machine. Fitting most burs with different shapes. Noiseless and easy maintenance motor with shaft mounted on dust protected ball bearings. Dynamically balanced rotor to be used with a central suction or a dry suction unit like **Am28** or a wet suction unit like **Wetty**.

Code X30A4

Features and technical data	UNDERMILL
Max consumption	Watt 130
Rpm	2.800
Power supply	230 V - 50 Hz
Height	31 cm
Dimensions	Height 29 cm - Diam. 19,5 cm.
	Weight kg. 5
Bur	Tungsten Ø 6 mm



## DRILLY

Ensuring the highest drilling precision in dowel pins technique, **Drilly** can be used with plexiglass, polycarbonate and any suitable plastic material as well as with any plaster, even the hardest one. The red laser beam gives the exact drilling point. Motor shaft mounted on dust protected ball bearings. Dynamically balanced rotor.

Code X29A4

Features and technical data	DRILLY
Max consumption	Watt 150
Rpm	2.800
Power supply	230 V - 50 Hz
Dimensions	Height 40 cm - Width 19 cm
	Depth 18 cm
Weight	12 kg
Bur	Tungsten Ø 6 mm

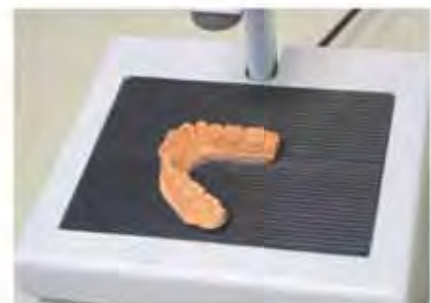

## SAWY & SAWYLASER

**Sawy** diamond blade disc saw for model stump technique. Constant torque, d.c. motor, 6000 rpm., powered through transformer. Two-hands safety protection. Built-in suction with filter. Ball-joint model holder with magnetic locker. High quality diamond blade. **Sawylaser**: same as **Sawy** but equipped with high precision laser beam showing the exact cutting line.

Code X28A4    Code X28B4

Features and technical data	SAWY
Rpm	6.000 constant couple
Power supply	230 V - 50 Hz
Dimensions	Height 32 cm - Width 25 cm
	Depth 30 cm
Weight	15 kg



## CHISY 6

Pneumatic chisel operating with up to 6 bar pressure. Thanks to the very light and easy-to-use handpiece, **Chisy 6** can easily remove investment from castings and plaster surplus but it is also designed for models shaping. 3 different shape tools included.

Code Q10C1

# Waxpots Kery



cod. X 76 A4

## KERY 1

Suitable for the dipping technique. Fast heating without overshoots thus allowing the wax to glue well and uniformly to the stump.

Features and technical data	KERY 1
Power supply	230 V - 50 Hz
Max consumption	60 W max
Working temperature	50 - 120° C
Dimensions	Depth 14 cm Width 11 cm Height 6,5 cm



cod. X 78 A4

## KERY LARGE

designed for the wax up in the partial and removable techniques allowing a constant density and uniformity of the wax.

Features and technical data	KERY LARGE
Power supply	230 V - 50 Hz
Max consumption	120 W max
Working temperature	50 - 120° C
Dimensions	Depth: 12 cm Width 19 cm Height 7,5 cm



cod. X 77 A4

## KERY 4

allows to heat up to four waxes using four separates pots. The larger pot is commonly used for the wax of major consumption. The high accuracy temperature control with digital display grants the uniformity in all the pots. Fast heating without overshoots. When not in use, a cover protects the wax from pollution.

Features and technical data	KERY 4
Power supply	230 V - 50 Hz
Max consumption	120 W max
Working temperature	50 - 120° C
Dimensions	Depth: 12 cm Width 19 cm Height 7,5 cm



cod. X 74 A4

## MODY ONE

Electric wax carving device for freehand waxup as well as for use with surveyor. Very light pencil. "Quick-slip and lock"

Features and technical data	MODY ONE
Power supply	230 V - 50 Hz
Max consumption	12 W max
Working temperature	50 - 200° C
Dimensions	Depth 11 cm Width 7 cm Height 6,5 cm



tools drawer



cod. X 74 A4

## MODY TOUCH

Besides all the mody one performances, mody touch is the most advanced and complete wax carver keeping the "easy touch" device and feeding two independent pencils. With the "easy touch" device it is enough to touch the top ring of the pencil to switch between the two pre-set temperatures. mody touch is supplied with complete set of six pencils.

Features and technical data	MODY TOUCH
Power supply	230 V - 50 Hz
Max consumption	20 W max
Working temperature	50 - 200° C
Dimensions	Depth 12 cm Width 14,5 cm Height 8,5 cm



"easy touch" pencil



KIT 6 tools cod. 61880100



cod. X 80 A4

## HEATOOL electronic induction bunsen

The electronic induction bunsen heatool is the safest way to carve the wax during the wax up.

A double proximity sensor allows to heat the tool in 2 seconds only. When heatool starts to heat, the led switches from green to red thus ensuring the operator about the status.

If no tool is on the heating area, heatool switches on standby position (green led on) saving the precious energy.

Features and technical data	MODY ONE
Power supply	230 V - 50 Hz
Max consumption	100 W max
Dimensions	Depth 19 cm Width 9 cm Height 9 cm



The accuracy of the proximity sensors can be easily gauged acting on the sensitivity screw



the red led lights on when heatool is heating!  
In 2 seconds the tool is hot!

# Sandblasting



## SABLomat AND MINISABLomat

SABLomat has been designed for medium and large production laboratories. The revolving basket holds up to 12 frameworks to be automatically sandblasted. A manual cycle may be run for finishing.

A closed-loop suction system prevents the dust from scattering and deposit it into a movable filter-tray. A low-voltage long-life lamp insures good illumination. A metal screen acts as a barrier against the abrasion of the view glass.

MINISABLomat has the same features as **Sablomat**, however it is not equipped with closed-loop filter suction system.

It has been designed for connecting to either a central suction system or a dry suction system as **Am28** or a suction unit with dust-abatement water system as **Wetty**.

### Instruments:

SABLomat and MINISABLomat are equipped with the following:

- Tetrabor nozzle for use with abrasives up to 500  $\mu$  (grain 36).
- Timer of the automatic sandblasting cycle, up to 30 min cycle time.
- Nozzle pressure regulator and pressure gauge.
- Dehumidifier filter.
- Auto/Manual cycle changeover switch.
- Air control push-button in the manual working mode.
- Designed for connecting to the micro-sandblasting module **SYLOX K**.



The tetrabor nozzle, long-lasting and fitted with a suitable filter, prevents foreign matters from clogging the machine (12-month warranty).

Code 80003220



## SMALLBLAST

Manual sandblaster for small and medium size laboratories. High performance in removing plaster from castings. Large window allowing an excellent view of the working area.

It has been designed for connection to either a central suction system or a dry suction system as **Am28** or to a suction unit with dust-abatement water system as **Wetty**. Designed as well for connection to the micro-sandblasting module **Sylox k**.



Power supply	SABLomat	MINISABLomat	SMALLBLAST
230 Volts - 50 / 60 Hz	B01A4	B10A4	B12A4
110 Volts - 50 / 60 Hz	B01A1	B10A1	B12A1

Features and technical data	SABLomat	MINISABLomat	SMALLBLAST
Max consumption	180 W	66 W	9 W
Width	55 cm	55 cm	35 cm
Depth	60 cm	45 cm	29 cm
Height	70 cm	55 cm	39 cm
Net weight / Gross weight	75 kg / 95 kg	39 kg / 82 kg	8,6 kg / 10,6 kg



Safety sealed plug and pouring cap

Abrasive size • Pressure nozzle • Recommended procedures and implementations								
Name	Type	$\mu$	Grain	Nozzle (mm)	Pressure (bar)	Procedure	Use - Alloys	Pack Kg
BK500	Brown corundum	500	36	3,0	4-8	Coating removal and roughing	Cr-Co and non-precious alloys	5-25
WK350	White corundum	350	46	3,0	4-8	Coating removal and roughing	Cr-Co and non-precious alloys	5-25
WK250	White corundum	250	60	3,0	4-8	Coating removal and roughing	Precious alloys	5-25
OAL250	Aluminium oxides	250	60	2,0	3-4	Retention and preparation for pickling	Deep retention and composites	5-25
OAL105	Aluminium oxides	105	120	1,2	2-3	Retention and preparation for pickling	Medium retention and composites	5-25
OAL95	Aluminium oxides	95	150	0,8	2-3	Retention and preparation for pickling	Resin and ceramic	5-25
OAL80	Aluminium oxides	80	180	0,8	2-3	Retention and preparation for pickling	Ceramic	5-25
OAL50	Aluminium oxides	50	270	0,5	2-5	Retention and preparation for pickling	Ceramic	5-25
MP200	Quartz microspheres	200	-	3,0	3-4	Satin finishing and polishing	All metals	5-25
MP90	Quartz microspheres	90	-	0,8	2-3	Satin finishing	All metals	5-25
MP55	Quartz microspheres	55	-	0,5	2-3	Satin finishing	All metals	5-25



## MICROSANDBLASTERS OXYKER DUET – TRIO – QUARTETTO

The pencil micro-sandblasters OXYKER DUET, TRIO and QUARTETTO may use either aluminium oxide or glass pearls in order to carry out the roughing, buffing and polishing of metals, ceramic and acrylic materials. OXYKER DUET – TRIO - QUARTETTO can work with any kind of abrasive in the range from 50 µ to 250 µ.

OXYKER DUET – TRIO - QUARTETTO are preset for the installation of an additional sandblasting module up to four modules.

OXYKER DUET – TRIO are also equipped with a quick-release suction pipe connection to work through either a central suction system or a dry suction system as Am28 or a suction unit with dust-abatement water system as Wetty.

A diffused lighting, well distributed permits working under optimal visibility with no shadows on the working area and direct light to the operator's eyes.

Pressure regulator with gauge and dehumidifier filter. Easy to grip and handle pencils with nozzle of Ø 0, 8 mm - 1, 2 mm - 1, 5 mm – 2 mm

Multi purpose abrasive selector ergonomically located inside the sandblasting room.

Air blowgun to remove any trace of dust.



Easy to grip and handle pencils



Multi purpose abrasive selector ergonomically located inside the sandblasting room.



Air blowgun to remove any trace of dust.

	230 Volts - 50 / 60 Hz	Duet B16A4	Trio B16B4	Quartetto B16C4
	110 Volts - 50 / 60 Hz	Duet B16A1	Trio B16B1	Quartetto B16C1
Features and technical data	OXYKER DUET	OXYKER TRIO	OXYKER QUARTETTO	
Max consumption	40 W	40 W	40 W	
Width		44 cm		
Depth		48 cm		
Height		33 cm		
Net weight / Gross weight	18 kg	19 kg	20 kg	

## SILOX K

Mobile sandblasting delivery system, which can be installed on any sandblasting machine like Sablomat, Minisablomat, Smallblast, or installed as a further delivery silo on microsandblaster Oxyker Duet or Trio. Sylox K is very appreciated in the dental practice where it is also supplied with the safe working box Finybox and the mobile exhauster Dustyclean.

Nozzle Ø 1.2 mm - Air-powered pedal - Dehumidifier filter - Pressure regulator with gauge.

Features and technical data	SYLOX K
Width	10 cm
Depth	17 cm
Height	30 cm
Net weight / Gross weight	2.7 kg / 3.5 kg



Code B08A4

# Suctions



## AMF

Multifunction suction unit, designed to be used with dry model trimmers. This unit may work in conjunction with metal cutters, sandblasting machines, working benches or any other equipment where the removal of important quantities of dry dust is required. Strong enough to work simultaneously on several machines when properly connected.

230 Volts - 50 / 60 Hz	X11A4
110 Volts - 50 / 60 Hz	X11A2

Features and technical data	AMF
Max consumption	1100 W
Diameter	31 cm
Height	60 cm
Net weight / Gross weight	16 kg / 19 kg



## AM28

The handy dry suction unit **am28** can be used with sandblasters like **minisablomat** or **small-blast**, pencil sandblasters like **oxyker duet** and **trio**, working boxes like **finybox**, working benches, **undermill**, **cutty** and with any other dental machine.

Regulation of motor speed in order to grant proper suction to the machine to be connected. Supplied with hose, quick release connection, spare filter bag.

230 Volts - 50 / 60 Hz	X16A4
110 Volts - 50 / 60 Hz	X16A2

Features and technical data	AM28
Max consumption	800 W
Width	26 cm
Depth	33 cm
Height	42 cm
Net weight / Gross weight	12 kg / 13 kg



FB4 - 4 filter pack for AM28

Code 60410100



## WETTY

Suction unit using water spray system for the abatement of the dust created by small dental machines, especially during sandblasting procedures. Suitable for any dental lab, it can be easily connected to sandblasters, pencil sandblasters, metal grinders, **undermill**, **cutty** and to any other dental machine requiring a silent, reliable, safe and easy plug-in suction system.

230 Volts - 50 / 60 Hz	X31A4
------------------------	-------

Features and technical data	WETTY
Air consumption	37 l/m - 3 bar
Width	26 cm
Depth	25 cm
Height	40 cm
Net weight / Gross weight	6,5 kg / 7,5 kg







## HANDYFAN

Handy hood equipped with activated charcoal filter exhauster. To be located on a working table or everywhere unsafe vapours, steams or gases arise. When mixing acrylic or other chemical liquid and solid, when soldering or heating microflame, when removing thin particles from plastic or ceramic elements, **Handyfan** grants good environment and individual protection.

Code X41A4

Features and technical data	HANDYFAN
Max consumption	19 W
Width	45 cm
Depth	44 cm
Height	32 cm
Acoustic noise	36 dB
Net weight	3,0 kg
Gross weight	3,8 kg



## FINYBOX

Compact milling box specifically designed for the finishing, FINYBOX is extremely appreciated in the dental practice to finish prosthesis and for final touch on ceramic elements or bridges, acrylic or metal to be done with micromotor or pencil sandblaster.

The **magnifying front screen** gives a brighter and detailed sight to the operator.

The **inclined relief** on the bottom side is very helpful to support the model or the item to finish.

Highly recommended for small jewellery shop to finish and clean the objects without loss of precious metal particles and dust.

The bottom is designed to allow an easy access to suction equipments to keep the FINYBOX always clean and to collect the particles of precious alloys dispersed during the finishing and polishing.

We suggest the use of FINYBOX with mobile exhauster AM28 or WETTY.

Code X43A4

Features and technical data	FINYBOX
Sizes	Width 40cm Depth 36cm Height 24cm
Net weight / Gross weight	2,2 kg



FINYBOX WITH  
MICROMOTOR FM21



FINYBOX WITH  
SANBLASTING MODULE SYLOX K

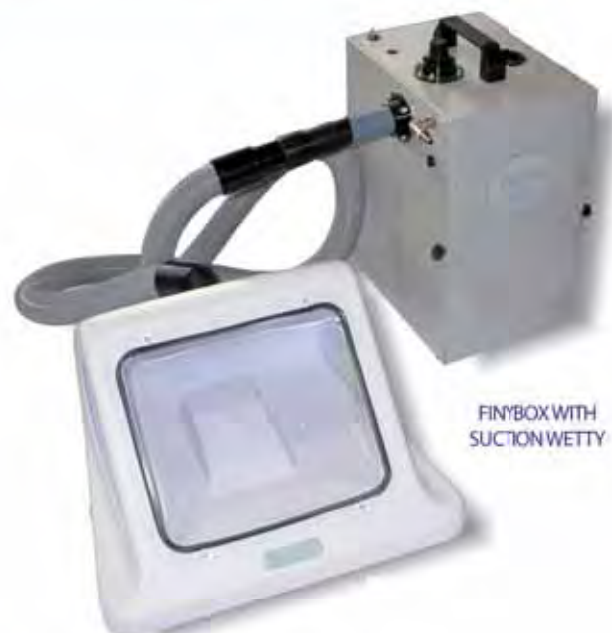

FINYBOX WITH  
SUCTION WETTY

# Syloplaster & lift-o-plaster



## SYLOPLASTER

Dispenser containing up to 30 kg of plaster. The inside rubber container is sealed against humidity to avoid the spoiling of plaster or investment. When the pouring diaphragm is opened, a vibrating device starts to operate thus ensuring a uniform flowing of the powder without stones avoiding the plaster clogging.

230 Volts - 50 / 60 Hz	V09A4
110 Volts - 50 / 60 Hz	V09A1

Features and technical data	SYLOPLASTER
Max consumption	200 W
Height	71 cm
Width	40 cm
Depth	31 cm
Net weight less powder	28,5 kg
Net weight with powder	56 kg
Acoustic	< 70 dB(A)

## LIFT-O-PLASTER

Lifter to be fixed on the wall to easily move the SYLOPLASTER up and down, in filling and working position. It is easy to operate and 100% safe against any kind of accident.

Code V10A0

## SFS

SFS is a furniture designed to obtain the maximum of safety and ergonomcy using SYLOPLASTER + LIFT-O-PLASTER.

Code V11A0



Just pulling the lever, the plaster start to fall down

## CORRECT USE OF SYLOPLASTER + LIFT-O-PLASTER



unplug



remove the plate



remove the plaster drum



open the side carter



now use SYLOPLASTER as per instruction manual



lift down SYLOPLASTER



remove the upper plate



pour the plaster



lift up SYLOPLASTER



after pour replace the air bag filter

# Mixing & Vibrators



MIXYVAC 5 is used for mixing plasters or die stone. MIXYVAC 5 is extremely ergonomic and may be either wallmounted or placed on a bench stand.

## MIXYVAC 5

- Equipped with a powerful, silent, built-in vacuum pump.
- Double timer with time-delay switching of the suction pump.
- Digital display.
- Built-in vacuum gauge. Simplified filling and emptying of the mixing bowls.
- Mixing bowl, 170 c.c. capacity (inclusive of cover and mixing blade).

### Optional:

- Mixing bowl, 560 c.c. capacity (inclusive of cover and mixing blade).

230 Volts - 50 / 60 Hz	X21A2
110 Volts - 50 / 60 Hz	X21A1

Features and technical data	MIXYVAC 5
Max consumption	150 W
Width	39 cm
Depth	26 cm
Height	45 cm
Net weight / Gross weight	14 kg / 16 kg



## SPARE PARTS

Mixing bowl, 170 c.c. capacity (inclusive of cover and mixing blades) suggested for small quantity of plaster, well as for crowns and bridges etc.

**This bowl is supplied as standard accessory with MIXYVAC 5.**

**Code 83000010**

Mixing bowl, 560 c.c. capacity (inclusive of cover and mixing blades) Suggested for large quantity of plaster well as for many cylinders or for partials.

**This bowl is supplied as extra optional with MIXYVAC 5.**

**Code 83000020**



## RING

Small-size vibrator, especially suitable for the impression models in dentist offices or small laboratories.

- Rubber table removable for cleaning.
- Selector switch with two intensity settings.

230 Volts - 50 / 60 Hz	V01A4
110 Volts - 50 / 60 Hz	V01A1

Features and technical data	RING
Max. consumption	22 W
Useful diameter	14 cm
Height	10 cm
Net weight / Gross weight	.2 kg / 2,5 kg

## PULSAR

The vibrators PULSAR 2, PULSAR 4, PULSAR 6 and PULSAR LARGE, respectively for 2, 4, 6 and 18 large rings, have been carefully designed to facilitate any kind of investment or stone.

Due to the new electronic control system, the vibration is perfectly vertical and the vibration intensity may be set from the lowest intensity, almost imperceptible, up to a maximum intensity value, much stronger than would be required for, even by the most difficult casting.

### Features:

- Continuous vibration, perfectly vertical, and continuous vibration control.
- Illuminated switch.
- Rubber table removable for cleaning.

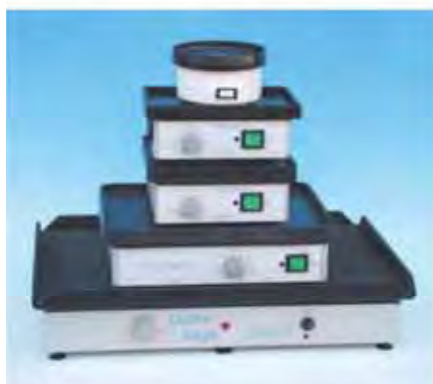

Power supply	PULSAR 2	PULSAR 4	PULSAR 6	PULSAR LARGE
230 Volts - 50 / 60 Hz	V02A4	V04A4	V06A4	V07A4
110 Volts - 50 / 60 Hz	V02A1	V04A1	V06A1	V07A1

Features and technical data	PULSAR 2	PULSAR 4	PULSAR 6	PULSAR LARGE
Max. consumption	220 W	220 W	220 W	550 W
Width	25 cm	24 cm	37 cm	60 cm
Depth	16 cm	24 cm	27 cm	40 cm
Height	11 cm	11 cm	11 cm	11 cm
Capacity (large rings)	2	4	6	18
Net weight / Gross weight	5 kg / 5,5 kg	6,5 kg / 7 kg	10 kg / 10,5 kg	26 kg / 27 kg

# Model trimmers & Grinders



## TGE

Model trimmer, very silent and sturdy, equipped with solenoid valve to control the water inlet. Safety switch for protection against any accidental start of the motor. Adjustable working table.

### Features:

- Ø 26 cm disc
- Speed rate: 1400 r.p.m.
- Possibility to use alternatively:  
standard-grained disc (delivered with TGE)  
medium-grained disc  
fine-grained disc  
diamond disc:

Features and technical data	TGE - TGE ORTHO - TG AIR
Max consumption	330 W
Width	35 cm
Depth	40 cm
Height	32 cm
Net weight / Gross weight	19 kg / 20 kg

### Optionals:

- Orthodontic kit including:  
scaled working table - goniometer - square model clamp.

Code X02B0



## TG AIR

Dry model trimmer, featured as the trimmer type TGE. Delivered only with diamond disc. To be used in conjunction with an adequate suction unit as AMF.

### Optionals:

- Orthodontic kit including:  
scaled working table - goniometer - square model clamp.

Code X02B0



## TGE ORTHO

Same as TGE, but with:

- Fine-grained disc.
- Orthodontic kit including:  
scaled working table - goniometer - square model clamp.



Scaled working table, goniometer.



Square model clamp, goniometer.

230 Volts - 50 Hz	X02B4
230 Volts - 60 Hz	X02B401
110 Volts - 50 Hz	X02B2
110 Volts - 60 Hz	X02B201



## DUALTRIM

The double disc model trimmer DUALTRIM has been designed to meet the need even of the most sophisticated orthodontist. The 2 motors can be activated alone or together. Also the 2 water outlets can be separately regulated. The discs, the first coarse to cut and the other fine to finish, can be used with graduated goniometer and a model press on the angulated table.

### TECHNICAL FEATURE

- 2 motors each of 450 watt power and 1400 rpm
- 2 reinforced Ø 300 mm abrasive discs
- 2 solenoid valves



Graduated goniometer and model press on the angulated table.

Voltage 220 - 240 V - 50/60 Hz

Code X81A4

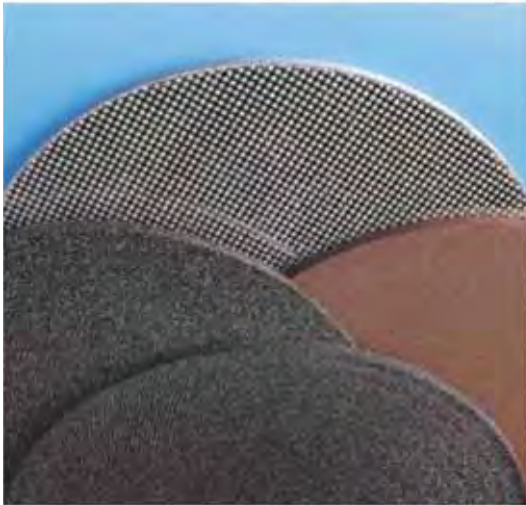

## GRINDING DISCS

The MANFREDI corundum grinding disc are available in three different trimming roughness:

- STANDARD gross roughness
- MEDIUM regular roughness
- FINE for finishing in orthodontic models

The direction of the rough lines is designed to help an easy plaster-water flowing away.

The corundum discs are usable on both sides so that when one side is spoiled it can be used the back one can be used as new.

The diamond disc, designed for dry trimmer like TG AIR, is also suggested for a very longlasting use on the water cooled trimmers like TGE, TGE ORTHO, DUALTRIM.

All discs have the external diameter of 254 mm, while the central hole diameter is of 25 mm and the thickness is 6,5 mm



- Standard-grained disc **Code X02D0**
- Medium-grained disc **Code X02D2**
- Fine-grained disc **Code X02D1**
- Diamond disc **Code X02D3**



## CUTTY

The high speed grinder CUTTY is essential in every prosthesis framework laboratory.

- Variable speed up to 26.000 r.p.m.
- Adjustable lamp with protection screen.
- Automatic spindle.
- Oil-less bearings, maintenance-free.
- It has been designed for connection to either a central suction system or a dry suction system such as **Am28** or a suction unit dust-abatement water system such as **Wetty**.



*The speed of CUTTY chuck is finely regulated with a continuous control driven by a rotating knob.*

230 Volts - 50 / 60 Hz

X13A4

110 Volts - 50 / 60 Hz

X13A1

### Features and technical data

Features and technical data	CUTTY
Max. consumption	245 W
Width	31 cm
Depth	35 cm
Height	28 cm
Net weight / Gross weight	15 kg / 20 kg



Code X68A4

**FM35**

compact portable brush micromotor - up to 35.000 r.p.m. - on/off switch  
 progressive start foot - low speed automatic torque adjustment  
 continuous speed control on the box - forward/reverse switch - hand/foot switch  
 tools and handpiece trays on the control box - light handpiece: 208 g!  
 suitable for nylon work - **suggested for final touch in the dentist practice!**

Features and technical data	control box	handpiece
voltage	100/240 v - 50/60 hz	230 v - 50/60 hz
Torque/speed		2,7Nm / 35.000rpm
power	45 w	
weight g	1234 g	208 g
Sizes mm	118(w) x 156 (d) 78 (h)	154 (l) - 28 Ø



Code X57A4

**FM21**

from 1.000 up to 45.000 r.p.m, brush micromotor best performances - 3.0 Nm  
 ceramic ball bearings to grant a longlasting life  
 "no-dust" protection makes easy and troublesless the daily job  
 very low noise and minimal vibrations - 2 mt long cable - torque.

Features and technical data	control box	handpiece
voltage	230 v - 50/60 hz	230 v - 50/60 hz
Torque/speed		3 Nm / 45.000 rpm
power	50 w	
weight	2600 g	200 g
Sizes mm	245(w) x 260 (d) 100 (h)	150 (l) - 28 Ø



Code X58A4

**HF50**

induction micromotor with variable speed from 1,000 to 50,000 - torque 7.8 Nm  
 designed for the technician requiring the power and friendly handling  
 the autocruise function maintains the constant speed once it has been fixed.

Features and technical data	control box	handpiece
voltage	230 v - 50/60 hz	230 v - 50/60 hz
Torque/speed		7,8Nm/50.000rpm
power	230 w	
weight g	2900 g	238 g
Sizes mm	245(w) x 260 (d) 105 (h)	159 (l) - 27 Ø



Code X60A4

**TREKO50**

Induction micromotor from 1000 to 50000 r.p.m. - torque 7,8 Ncm  
 constant speed - hand to foot fast switch r.p.m. control (pedal included)  
 table top or knee control easy change (fixing bracket included)  
 r.p.m. digital display - forward/reverse one touch button  
 autocruise function after 2" foot/knee constant pressure

Features and technical data	control box	handpiece
voltage	100/240 v - 50/60 hz	230 v - 50/60 hz
Torque/speed		7,8Nm/50.000 rpm
power	230 w	
weight g	2900 g	238 g
Sizes mm	94(w) x 268(d) 228 (h)	159 (l) - 27 Ø



## M2V

Bench-type polishing lathe machine, 2-speed, very silent and sturdy. Equipped with safety switch for protection against any accidental start of the motor. The European Directive makes it necessary that bench-type polishing lathes be used only with suitable protection device as the suction unit **ASPYCLEAN**.

### Instruments:

- Pilot light.
- 2-wheel spindle cones (R.H. + L.H.).
- 2-speed rates: 1400 / 2800 r.p.m.

230 Volts - 50 / 60 Hz	X01A4
110 Volts - 60 Hz	X01A1



Features and technical data	M2V
Max consumption	260 W
Width	50 cm
Depth	22 cm
Height	24 cm
Net weight / Gross weight	11 kg / 12 kg



## ASPYCLEAN

Suction unit for polishing lathe machines, built in compliance with the European Directive. While being very silent, **ASPYCLEAN** has an exceptional suction capacity. A diffused lighting, well distributed, permits working under optimal visibility. All the parts in contact with water are in stainless steel and painted. The filter cleaning and the dust removal are extremely simple and trouble-free. It may be delivered alone or with polishing lathe **M2V** already assembled.

### Instruments:

- Illuminated with neon lamp.
- 2 gates, with the possibility of closing off the suction on the unused side.
- 2 safety screens, transparent and adjustable.
- Ergonomic store for instruments.

Power supply	ASPYCLEAN	ASPYCLEAN + M2V
230 Volts - 50 Hz	X00A4	X01B4
110 Volts - 60 Hz	X00A1	X01B1

Features and technical data	ASPYCLEAN	ASPYCLEAN + M2V
Max consumption	132 W	400 W
Width	68 cm	68 cm
Depth	51 cm	51 cm
Height	42 cm	42 cm
Net weight / Gross weight	35.5 kg / 46 kg	46 kg / 57 kg



## DEWAX 5

Stainless steel multi-purpose water bath for dental laboratory. **Dewax 5** can be used to remove wax from cylinders and from flask, or as a softener bath for plastic materials. **Dewax 5** can work as a water bath from 30 °C up to 90 °C, or as a dryer for operations requiring low temperature and controlled heating. Tank capacity 4 lt. (corresponding to 6 half large flasks or 6 casting rings 6X size).

230 Volts - 50 / 60 Hz	X45A4
Features and technical data	DEWAX 5
Width	20.5 cm
Depth	41 cm
Height	22 cm
Voltage	230V 50Hz
Max Absorption	3.6A
Power	0.83Kw
Max temperature	90°C



## ULTRA 3

Ultrasonic tank for dental laboratory (3,5 lt), equipped with high-output piezoelectric transducers with cone-frustum-shaped structure. Automatic variation of the absorbed power according to the shape and sizes of the parts to be cleaned, the level and the fluid temperature.

### Features:

- Automatic degassing at the cycle start.
- Fluid draining.
- Temperature setting in the range from 20° to 70 °C.
- Timer setting up to 22 minutes.

### Optionals:

- steel basket.
- plastic cover.
- holder for 3 beakers.
- 3 Pyrex beakers.
- drain with cock.

230 Volts - 50 / 60 Hz	X24A4
110 Volts - 50 / 60 Hz	X24A1



Features and technical data	ULTRA 3
Max consumption	180 W
Width	35 cm
Depth	21 cm
Height	24 cm
Net weight / Gross weight	5.8 kg / 7.7 kg

Code 65000110
Code 65000120
Code 65000130
Code 65000140
Code 65000150



### NEPHELES

Steamer for dental, jewellery, medical and industrial use.  
Built in compliance with the EC and the international safety regulations.

- Boiler in AISI 304 stainless steel, capacity 4,5 l.
- Heat protection with high-insulating material.
- Pipe fittings in stainless steel and copper.
- Electric power cut-out in case of water failure.
- Minimum level sensor switch.
- Work pressure: 4 bar.
- Safety valve.
- Emission of dry steam.
- Continuous steam emission lasting up to 42 minutes.
- Refilling: 3,3 l water.
- Reaching of working temperature in 10 minutes only.
- Ergonomic gun with hot water dropping protection.
- Hose designed for hot temperatures and pressures.

### HYDRONEPHELES

Besides the a.m. features, which shares with Nepheles, with Hydronepheles you have:

- Automatic refilling when connected to a water tap (including possibility of manual re-filling).
- Emission of dry steam, wet steam (steam + hot water), water.
- Continuous steam + water emission lasting up to 13 minutes.
- Continuous water emission lasting up to 5 minutes.
- Refilling and reaching of working temperature in 10 minutes only.
- Alternatively to the gun, the dry steam emission can take place through a fix nozzle.

WS - Water Softener (upon request)

Code X49WS



Power supply	NEPHELES	HYDRONEPHELES
230 Volts - 50 Hz	X51A4	X50A4
230 Volts - 60 Hz	X51A401	X50A401
110 Volts - 60 Hz	X51A1	X50A1

Features and technical data	NEPHELES	HYDRONEPHELES
Max consumption	1900 W	1900 W
Boiler capacity	4,5 l.	4,5 l.
Working pressure	4 bar	4 bar
Width	28,5 cm + 3,5 cm for the gun	28,5 cm + 3,5 cm for the gun
Depth	37,5 cm + 5 cm for the basin	37,5 cm + 5 cm for the basin
Height	32 cm + 5 cm for the cap	32 cm + 5 cm for the cap
Net weight / Gross weight	15 kg / 23 kg	17 kg / 25 kg



Fix steam nozzle.

**NEPHELES and HYDRONEPHELES** are equipped with very friendly maintenance devices. It is commonly known that the steamers need to have a periodical maintenance to eliminate the calcareous material.

Skipping this easy but compulsory operation, the components inside the boiler can be irre-remediably damaged.

The consequences can be the replacement of the complete boiler with all its components or of the whole equipment itself.

NEPHELES and HYDRONEPHELES have been designed with an easy-to-do maintenance device that can keep the steamers long-lasting as never before.





**NEW**

230 Volts - 50 / 60 Hz

X20D4

110 Volts - 60 Hz

X20D2

## MIXYGEL K

The model duplication is a delicate step of the framework production process, where a precise, sturdy and silent machine as MIXYGEL K is a basic requirement. MIXYGEL K has been designed taking into account the working load experienced in the dental technicians laboratories. A high tech, ergonomic mixer for pouring duplicating gel.

### Features:

- Double safety cover with interlock switch to prevent motor running when the lid is open.
- Silent and powerful motor.
- Pouring outlet reasonably far from the bearing plate.
- Automatic casting and gelatine maintenance cycle.
- Possibility of running a quick cooling cycle.
- Continuous temperature display.

Features and technical data	MIXYGEL K
Max consumption	660 W
Capacity	6 kg gel
Width	39 cm
Depth	39 cm
Height	53 cm
Net weight / Gross weight	19,5 kg / 30 kg

## ACRYDIG 6 - ACRYDIG 12

The polymerizing units ACRYDIG are completely built in stainless steel and painted. No electric component may come in contact, even accidentally, with water or steam, in conformity with the CE Directives. The special design of the machine closing cover avoids any scattering of vapours or condensation dripping, thus insuring the polymerization cycle to run in steam-saturated air. The wide opening and the proper dimensions of the polymerization tank permit uniform arrangement of the flasks. Due to its programmability, the ACRYDIG will run a polymerization cycle and automatically switch off at the end of the cycle itself, allowing the flasks to cool naturally, thus avoiding the resin micro-fractures, usually caused by an excessively aggressive cooling.

Instruments - The digital built-in controller makes programming extremely simple (3 keys only) - The program is indefinitely stored -The cycle is started or stopped through the RUN key - Every cycle step is continuously displayed.

### Working cycle

- X1 Raising to the pre-polymerizing temperature A1
- A1 Pre-polymerizing temperature.
- T1 Pre-polymerizing period.
- X2 Raising to the polymerizing temperature A2
- A2 Polymerizing temperature.
- T2 Polymerizing period.
- STOP Acrydig automatic switching off



ACRYDIG 6 & ACRYDIG 12 are provided of a fast connection tap to make easy the discharge of the dirty water



Power supply	ACRYDIG 6	ACRYDIG 12
230 Volts - 50 / 60 Hz	AD064	AD124
110 Volts - 50 / 60 Hz	AD061	AD121

Features and technical data	ACRYDIG 6	ACRYDIG 12
Max consumption	1100 W	1400 W
Inside dimensions:		
Width	15 cm	26 cm
Depth	31 cm	31 cm
Working height	26 cm	26 cm
Capacity	6-10 flasks	10-18 flasks
Outside dimensions:		
Width	19 cm	30 cm
Depth	42 cm	42 cm
Height	38 cm	38 cm
Net weight / Gross weight	8 kg / 9 kg	10 kg / 11 kg





## HYDRAULIC PRESS OL573

OL57 has been for tens of years the hydraulic press preferred by the dental laboratories and its success remains unchanged in spite of imitation. Now the model has been updated to OL573, which can host up to 3 flasks.

OL573 is the oil-pressure hydraulic press suitable for all the dental mechanic laboratories, and it is essential when high quality and continuous working results must be obtained.

The press OL573 has been so dimensioned as to work with half of its max. load applied: the pressure exerted at 200 Atm is 8000 Kg, while its max. load at 400 Atm is approx. 16000 Kg.

In case the pressing load exceeds 8000 Kg, a pressure relief valve goes into action in order to insure the highest safety.

1 pc. 00573C00 - 2 pc. 00573C02 6 pc. 00573C06	4 pc. 00573C04 12 pc. 00573C12
<b>Features and technical data</b>	
Working pressure	200 atm
Test pressure	400 atm
Width	20 cm
Depth	22 cm
Height	55 cm
Net weight / Gross weight	28,5 kg / 33 kg

## MANFREDI FLASKS AND CLAMPS



**340**  
Small round flask for bridges and crowns.

1 pc.	03400C00
6 pcs.	03400C01



**341**  
One-place clamp for flask 340.

1 pc.	03410C00
6 pcs.	03410C01



**330**  
4-section (upper, lower and 2 covers) flask for complete prosthesis.

1 pc.	03300C00
6 pcs.	03300C01



**105**  
Flask for complete prosthesis. Easy and quick deflasking device.

1 pc.	01050C00
6 pcs.	01050C01



**360**  
Anatomic-shaped flask for very wide prosthesis and palates, with quick-deflasking device.

1 pc.	03600C00
6 pcs.	03600C01



**361**  
One-place clamp for flask 330-105-360.

1 pc.	03610C00
6 pcs.	03610C01



**370/1 - 2 - 3**  
Self-locking clamp for hydraulic press accommodating respectively 1 or 2 or 3 flasks type 105-360-330.

1 pc.	03710C00
6 pcs.	03710C01

1 pc.	03720C00
6 pcs.	03720C01

1 pc.	03730C00
6 pcs.	03730C01

## SELF-LOCKING FLASK DR. COLOMBO

Flask for mobile prosthesis, either partial or complete. It permits the use of self-curing and thermo-curing materials. No clamp or press is required.

1 pc.	03900C00
-------	----------





### RINGS Rings in stainless steel AISI 304

10-pcs. pack Rings 1X ø 30 x 55	53510C01
10-pcs. pack Rings 2X ø 38 x 55	53520C01
10-pcs. pack Rings 3X ø 48 x 55	53530C01
10-pcs. pack Rings 6X ø 65 x 55	53560C01
10-pcs. pack Rings 9X ø 80 x 55	53590C01



### UNIVERSAL RUBBER SPRUE FORMER FOR RINGS

Universal rubber sprue former for rings ø 1X - 2X - 3X - 6X - 9X (6 pcs. pack)	Y01D0C06
Universal rubber sprue former for casting rings for Epeostos (6 pcs. pack)	Y01E0C06

### FREE EXPANSION SILICONE RINGS with plastic sprue bases

6-pcs. pack Rings 1X ø 30 x 55	53515C06
6-pcs. pack Rings 3X ø 48 x 55	53535C06
6-pcs. pack Rings 6X ø 65 x 55	53565C06
6-pcs. pack Rings 9X ø 80 x 55	53595C06



### FREE EXPANSION PLASTIC RINGS with plastic sprue bases

6-pcs. pack Rings ø 34 x 55	53734C06
6-pcs. pack Rings ø 50 x 55	53750C06
6-pcs. pack Rings ø 75 x 75	53775C06
100-pcs. pack Calcifiable cone former	5371C100

### CRUCIBLE HOLDERS - Very useful accessory, which makes casting operations easier.

For standard crucibles	T15A0	For large crucibles handling	T35A0
------------------------	-------	------------------------------	-------

### CRUCIBLE TONGS

Specifically designed to facilitate crucibles handling.

Code Y13A0

### CRUCIBLE TONGS - Specifically designed for Epeostos

Code Y24A0



### SELF-LOCKING TONGS FOR RINGS

To handle the hot rings safely. For rings from 30 to 80 mm Ø, 80 cm long

Code Y10A0



### MINIPICKLER

#### electrolytic Cr/Co and gold alloys polishing unit

- D.C. current generator, including:
- Steel frame
  - Amperometer 12 A
  - Power regulator with filter
  - Transformer 200 VA - 220/24 Volt
  - Timer 30'
  - Rectifier
  - Safety thermomagnetic switch
  - Main switch
  - Control lamp

#### sizes

width 230 x depth 245 x height 200 mm Weight 6,3 Kg

#### tank

sizes width 190 x depth 170 x height 190 mm - Weight 1,4 Kg - Capacity 2,7 liters

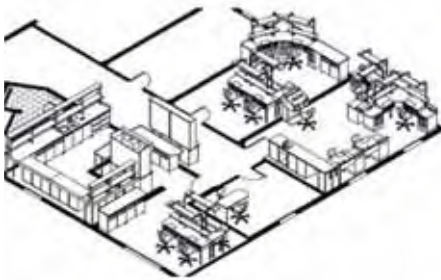
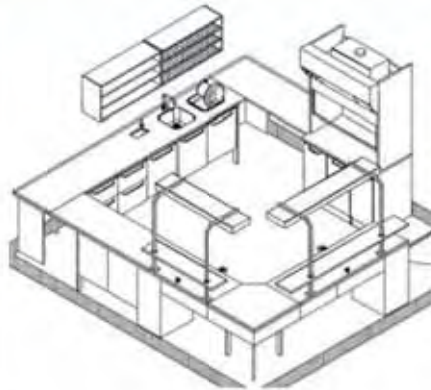
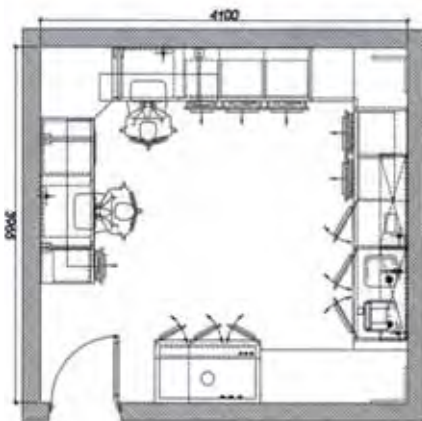

## SAED LINE

Following the requests we are receiving from our customers all over the world, we are today ready to supply complete "turn-key" dental laboratories, starting from the basic small individual labs, up to the largest and complete ones, including special designs for schools, hospitals and training centers.





## KALOSTERY B

**Fractionated vacuum** with with double-stage high performance pump.  
**Motor-operated closure** guarantees a total safety and a greater ease of handling.  
**Instantaneous Vaporizer** outside the chamber allows a higher sterilization speed and reduced water consumption.  
**Thermal printer on board** to allow the complete recording of the sterilization cycle.  
**Multi-language graphic display** to select the sterilization cycles.  
**Pc connection** to save on files.  
**Stainless steel chamber** for faster sterilization cycle, made of thick one-piece moulded steel.  
**Bowie and Dick - Helix Test - Vacuum Test.**

**STORE THE CYCLES ON YOUR COMPUTER!  
 ADD ONE MORE CHANCE TO SAVE YOUR AUTOCLAVE DATA!**

The autoclaves KALOSTERY B18 & B23 are also available in the versions B18+ & B23+.  
 Store the cycles on your computer thanks to the USB key!



KALOSTERY B

**be protected in case of loss or spoiling of the paper strip!**

The use of the USB key does not exclude the paper printing!

### Sterilizable products



Solid instruments



Hollow instruments



Wrapped instruments



Porous loads



KALOSTERY S



KALOSTERY N

# Index

Titanium	page 2
Laser welding	page 4
Induction casting	page 6
Vacuum pressure	page 7
Centrifuges	page 8
Crucibles	page 9
Pre-heating	page 10
Ceramic furnace	page 12
Welding	page 14
Projecting & Milling	page 16
Plasters models	page 17
Waxpots kery	page 18
Wax up mody carvers	page 19
Sandblasting	page 20
Microsandblasting	page 21
Suctions	page 22
Syloplaster & lift-o-plaster	page 24
Mixing & Vibrators	page 25
Model trimmers & Grinders	page 26
Micromotors	page 28
Polishing & Cleaning	page 29
Steamers	page 30
Duplicating and Polymerization	page 31
Hydraulic press, flasks and clamps	page 32
Casting accessories - Pickling unit	page 33
Saed line furniture	page 34
Autoclave sterilizators Kalostery	page 35

**Manfredi S.r.l.**

San Secondo di Pinerolo (TO) - Italy

ph +39 0121 501561 - fax +39 0121 500456

**[www.manfredi-saed.com](http://www.manfredi-saed.com)**